



Retrofit Corn Light

LTCA MODEL

Area Lighting Series



Luminaire LED

The LTCA LED luminaire is a patented design with unfolded fin type heat sink that provides a superior heat dissipation. It is an ideal solution for traditional area lighting retrofit, ie parking lots or street lights. LTCA080, 80W is to replace 250W HPS and LTCA110W, 110W is to replace 400W HPS.

Product Specifications

Features and Benefits:

- Modern and clean style
- Patented design for thermal management
- Luminaire efficiency :135 lm/w
- Surge Protection: 6KV
- Base E39
- Certification IP64
- 180 degree beam angle
- Flame retardant material
- >50,000 hours at L70
- 5-year warranty

Dimensions

- 80W closed: D4.37" x L8.70"
- 80W open: D4.37" x 11.10"
- 110W closed: D9.02" x L8.70"
- 110W open: D9.02" x L11.10

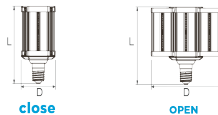

Applications:

- Parking lot and street lights



- Lumens** (+/- 200 lm):
80W - 10,800lm
110W - 14,850 lm

- Operating Temperature:** -40°C to 60°C

Electrical System:

Input Voltage: 100-277 VAC

Power Consumption: 80W & 110W

Construction/Finish:

- Aluminum body
- Polycarbonate lens



DLC #: GKS35-80W-01D3
Shenzhen Guanke Technologies



⚠ WARNING: THE LAMP BODY MUST BE EXTENDED WITH 2 SIDES TO LIGHT UP !



CAUTION: RISK OF ELECTRIC SHOCK-DO NOT USE WHERE DIRECTLY EXPOSED TO WATER. DO NOT USE WITH DIMMERS, FOR USE IN TOTALLY ENCLOSED RECESSED FIXTURES.

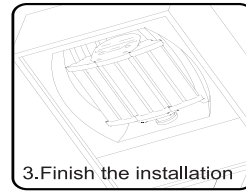
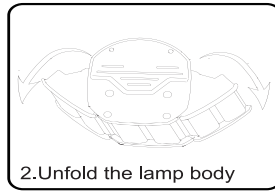
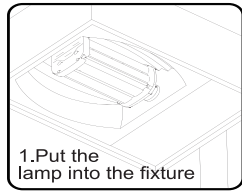

Installation

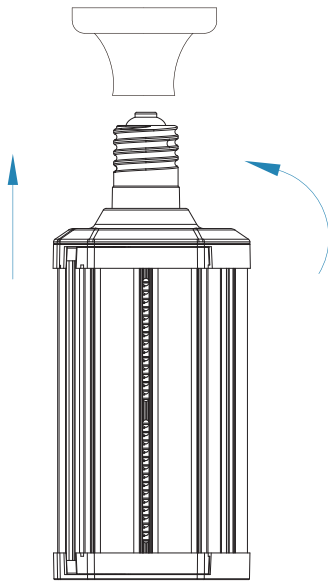

Step 1

Shown as Figure 1
Remove old ballast or disconnect from existing lamp holder. Remove and dispose of ballast in correct manner.

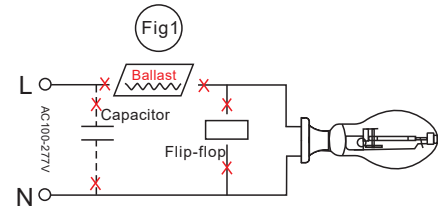

Step 2

Shown as Figure 2
Reconnect directly to the existing lamp holder.

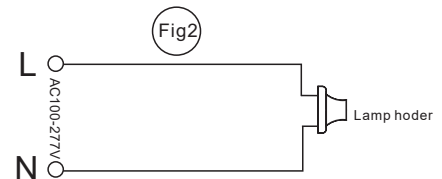

Step 3

Shown as Figure 3
Install new LED replacement lamp. Please make sure the old fitting is correctly earth.

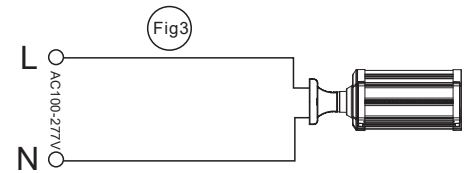

Light Distribution

80W: 9600+/-100lm

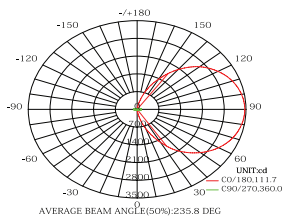

110W: 13200+/-100lm

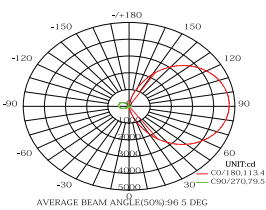

Ordering Information:

Example: **LTCA8050K**- LTCA model, 80W, 5000K, E39 Base



Model	Wattage	Color Temperature	Base		
LTCA	80	50K	B		
LTCA - Area Lights Retrofit	80-80W 110-110W	30K-3000K 40K-4000K 50K-5000K 57K-5700K	A-E26 B-E39		

Note: Specifications subject to change without notice. Actual performance may differ as a result of end user environment and application.